

# Handle on Fiberglass Helmets

## Contents

**HNDL-1 1.1 Handle On Fiberglass Helmets**

**HNDL-2 1.1.2 Handle Replacement On Fiberglass Helmets**

HNDL-1 1.1.1 Handle Removal

### 1.1 Handle On Fiberglass Helmets

#### 1.1.1 Handle Removal

**Tools required:**

- Flat Blade Screwdriver
- Torque Screwdriver and Flat Blade Attachment
- Dow Corning® RTV 732 Multi Purpose Sealant or Equivalent

cameras, lights, and other accessories. If the handle is to be drilled to accept any of these items, it must be removed to prevent accidental damage to the helmet shell.

**NOTE:** Weights only need to be removed if fiberglass damage of the helmet shell is suspected or mounting holes are to be drilled and tapped into the weights for camera or light mounting.

1) The handle is removed by first unscrewing the top three port retainer screws.

The handle is a convenient location to mount

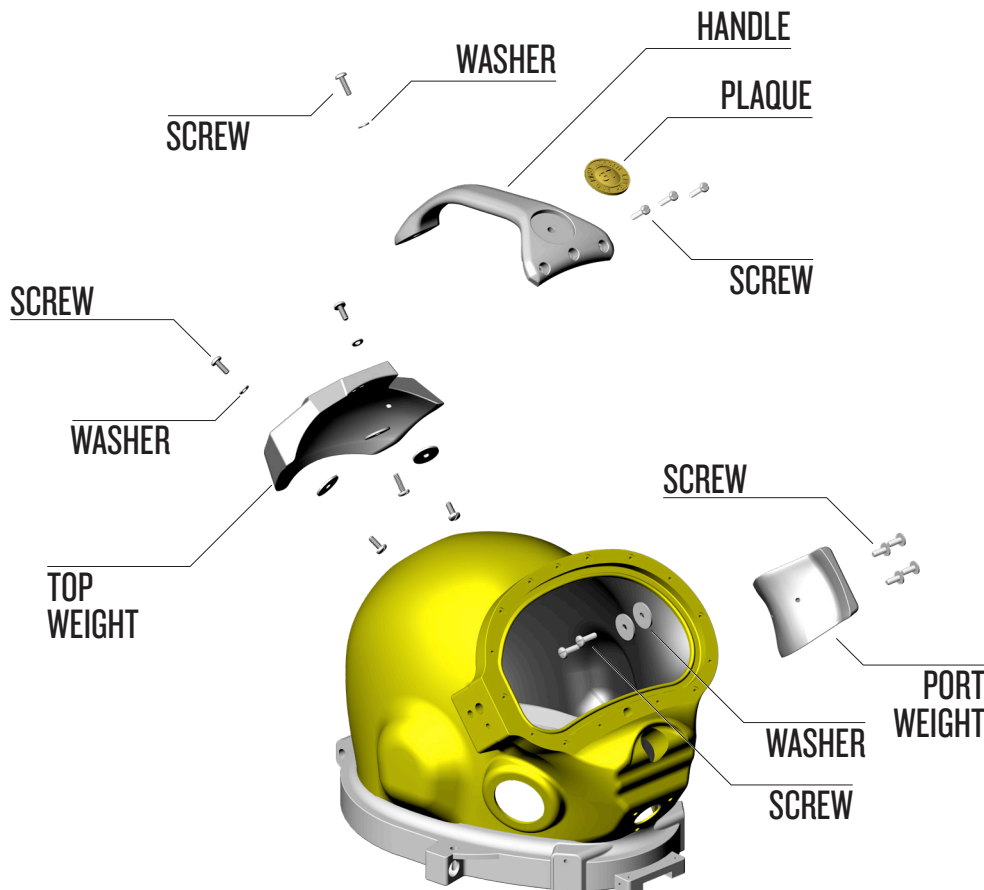

*Blowapart of the handle and weights.*



*Unscrew the top three port retainer screws.*

2) Remove the rear handle mount screw and washer.



*Remove the screw at the rear of the handle.*

### **1.1.2 Handle Replacement On Fiberglass Helmets**

1) Position the handle and thread the front screws in only until snug.



*Position the handle on the helmet.*

2) Hold the handle in place and thread the rear mount screw with its washer see "Torque Specs" on page APNDX-19 for correct torque.

3) Tighten the front mount screws see "Torque Specs" on page APNDX-19 for correct torque.