



Kirby Morgan Dive Systems, Inc.®

1430 Jason Way, Santa Maria, California 93455

Phone: 805/928-7772 Fax: 805/928-0342

www.kirbymorgan.com e-mail: info@kirbymorgan.com

Product Bulletin - #15 of 2005

New Fasteners for Kirby Morgan Helmets and Masks Part Numbers 530-035, 530-040, 530-045

October 14, 2005

KMDSI has begun switching as many of the fasteners on our helmets and masks as possible to “combo” head screws. You’ve probably seen these screws in other applications, they’re the ones that allow you to use either a Phillips head or slotted screwdriver to adjust them. Of course, you should use a torque screwdriver to tighten these fasteners wherever specified torques are called out in the applicable KMDSI manual.

The Combo screws that we have sourced to date include the following part numbers:

- 530-035 which is used on the port retainer on all current KMDSI helmets
- 530-045 which is used to secure the front of the handle and on the whiskers on all current KMDSI helmets
- 530-040 which is used to secure the port weight on the SuperLite-17B, all band mask bandkeepers, and KMACS-5 internal fasteners.

These stainless steel fasteners meet our specifications for thread pitch, corrosion resistance, and durability. They will make it faster and easier for all technicians to perform maintenance on Kirby Morgan products.

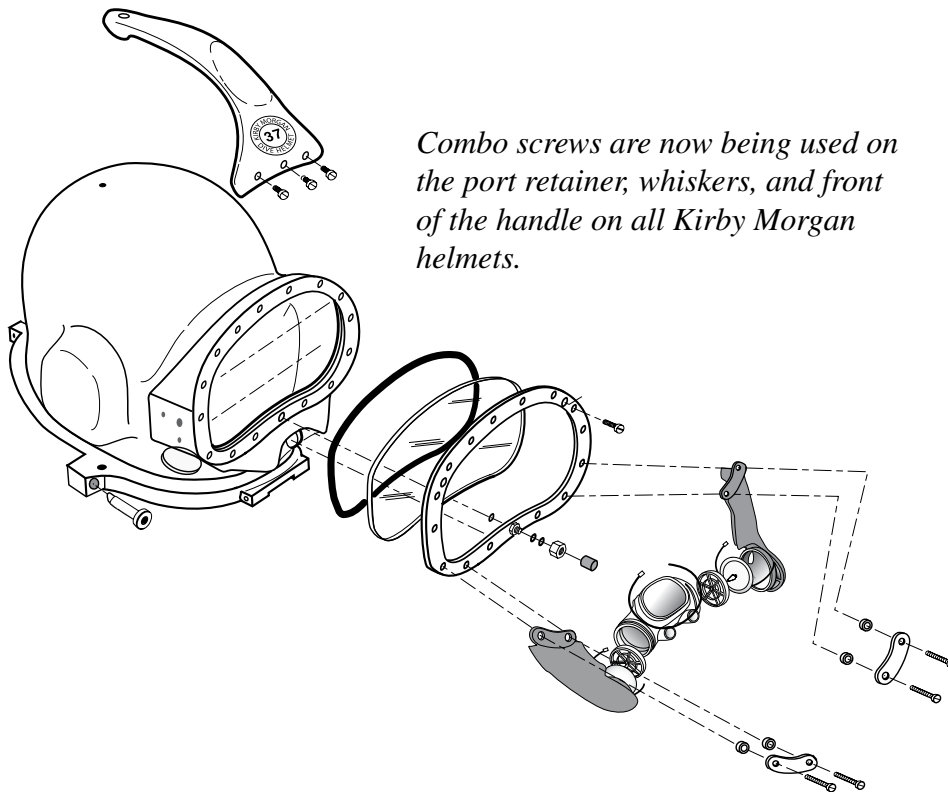

Genuine Parts