

# SuperFlow<sup>®</sup> 450 Regulator P/N 505-560

Location #	Part #	Description
1	550-050	Jam Nut
2	550-533	Bent Tube Adapter
3	510-017	O-ring
4	545-570	S.S. Reg Body Assembly.
5	510-015	O-ring
6	250-060	Nipple
7	210-050	O-ring, Adjustment Nipple
8	520-023	Bearing Clip
9	550-517	Main Tube
10	210-060	Valve Seat
11	Order 205-020	Inlet Valve
12	205-020	Inlet Valve Assembly
13	235-015	Spring
14	210-055	O-ring
15	550-549	Spacer, Balanced
16	510-017	O-ring
17	550-643	Transfer Pin
18	550-567	Adjustment Packing Nut
19	510-012	O-ring
20	550-640	Shaft Bearing Washer

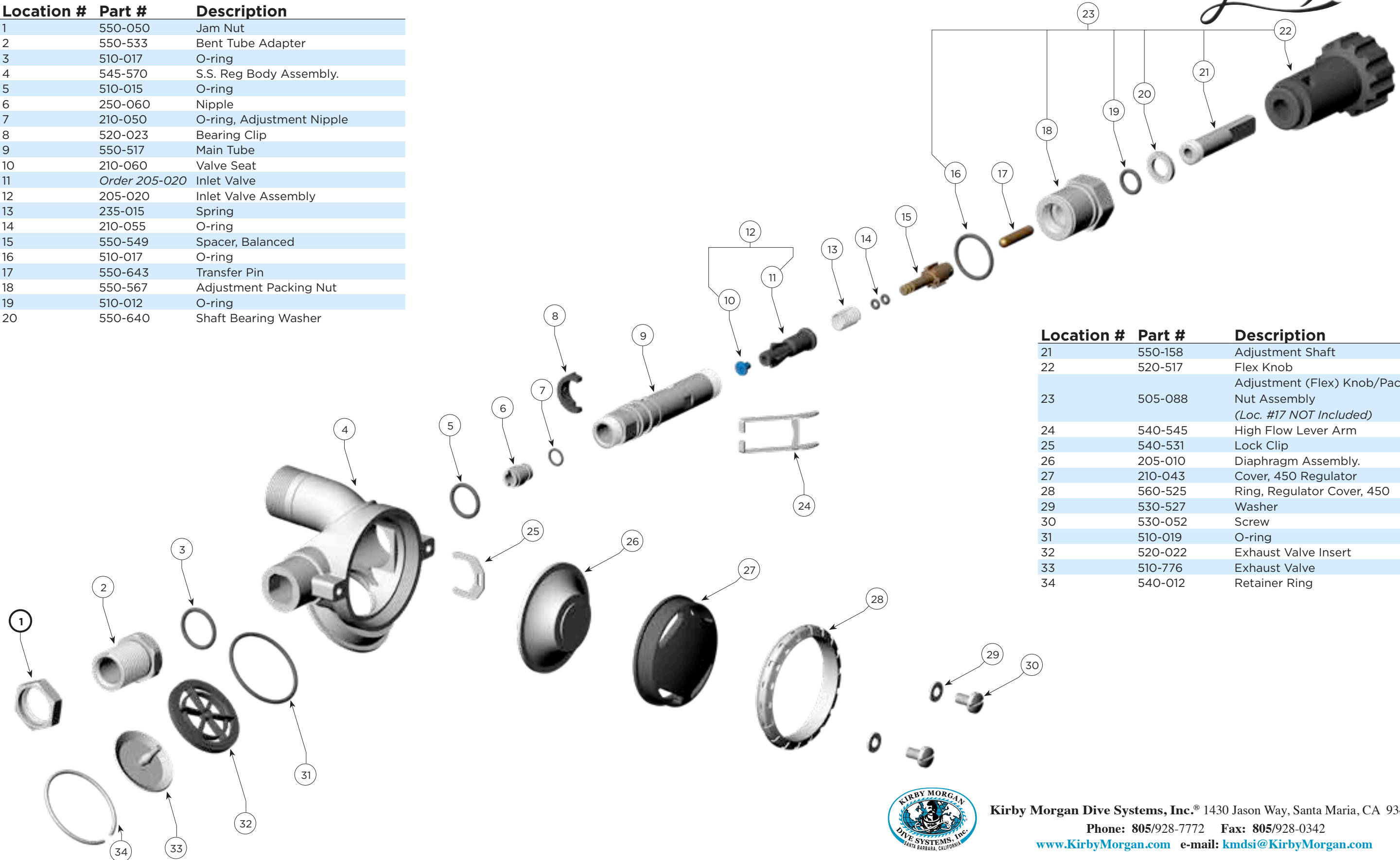

Location #	Part #	Description
21	550-158	Adjustment Shaft
22	520-517	Flex Knob
		Adjustment (Flex) Knob/Packing Nut Assembly (Loc. #17 NOT Included)
23	505-088	Nut Assembly
24	540-545	High Flow Lever Arm
25	540-531	Lock Clip
26	205-010	Diaphragm Assembly.
27	210-043	Cover, 450 Regulator
28	560-525	Ring, Regulator Cover, 450
29	530-527	Washer
30	530-052	Screw
31	510-019	O-ring
32	520-022	Exhaust Valve Insert
33	510-776	Exhaust Valve
34	540-012	Retainer Ring



Kirby Morgan Dive Systems, Inc.<sup>®</sup> 1430 Jason Way, Santa Maria, CA 93455  
 Phone: 805/928-7772 Fax: 805/928-0342  
[www.KirbyMorgan.com](http://www.KirbyMorgan.com) e-mail: [kmdsi@KirbyMorgan.com](mailto:kmdsi@KirbyMorgan.com)