

# SuperLite® 17C Helmet

P/N 500-599 / 500-600



Location #	Part #	Description
1	520-054	Visor
2	530-540	Washer
3	530-070	Screw
4	510-754	Head Cushion Assembly
	510-722	Head Cushion Bag
5	510-837	Head Cushion Foam Spacer Assembly (Order P/N 525-745)
	510-836	Head Cushion Foam Spacer Bag
6	510-683	Chin Cushion Assembly
	510-639	Chin Cushion Bag
7	505-024	Side Block Assembly (B)
8	520-033	O-ring, Teflon®
9	555-154	Bent tube Assembly, No O-rings
10	510-012	O-ring
11	555-155	Bent Tube Assem w/O-rings
12	560-125	Weight, Top
13	530-070	Screw
14	530-035	Screw
15	530-070	Screw
16	530-540	Washer
17	505-106	Helmet Shell, 17C with Ring
18	530-078	Screw
19	530-040	Screw
20	530-540	Washer
21	530-406	Washer
22	530-062	Screw
23	540-132	Mount Bracket, Starboard Side
24	540-133	Handle, SL 17C
25	540-130	Mount Bracket, Port Side
26	530-045	Screw
27	510-762	Air Train Gasket
28	530-050	Screw
29	530-535	Washer
30	530-415	Washer, Lock
31	530-317	Nut
32	545-016	Air Train
33	530-535	Washer
34	530-317	Nut
35	530-052	Screw
36	530-035	Screw
37	550-062	Knob, Nose Block
38	555-180	Packing Nut
39	510-008	O-ring
40	550-116	Nose Block Guide
41	560-070	Port Retainer, w/#40
42	510-010	O-ring
43	520-004	Face Port

Location #	Part #	Description
44	560-086	Weight, Port, SL 17C
45	510-260	O-ring, View Port
46	530-015	Screw
47	505-110	Sealed Pull Pin
48	530-032	Screw
49	530-059	Screw
50	540-039	Front Stand Off
51	550-063	Body, Water Dump
52	510-561	Valve, Water Dump, Black
53	510-033	O-ring
54	520-042	Tie Wrap
55	530-019	Screw
56	510-007	O-ring
57	560-530	Cover, Water Dump Adapter
58	505-111	Chin Strap Assembly Purchase 525-716 Kit
59	510-786	Starboard Whisker Wing
60	510-760	Quad Valve Exhaust Main Body
61	520-042	Tie Wrap
62	520-200	Whisker Exhaust Valve Insert
63	510-776	Exhaust Valve
64	520-118	Tri/Quad Valve Whisker Clamp
65	530-008	Brass Screw
66	530-009	Brass Nut
67	510-787	Port Whisker Wing
68	505-730	Quad Valve Exhaust Assembly
69	530-045	Screw
70	550-061	Spacer
71	540-015	Kidney Plate
72	505-069	SuperFlow® 350 Regulator Assembly Purchase 525-771 Kit
73	530-546	Washer for Swing Catch
74	530-035	Screw
75	550-061	Spacer
76	540-086	Swing Catch
77	520-167	Teflon® Washer for Swing Catch
78	535-825	Spring, Swing Catch
79	530-045	Screw
80	550-122	Spring Spacer
81	530-312	Clip, Hinge Pin
82	550-216	Front Yoke Hinge
83	530-018	Screw
84	530-311	Pin, Front Yoke Hinge
85	530-028	Lock Nut
86	560-111	Locking Collar
87	550-113	Adjustment Nut, Neck Pad

Location #	Part #	Description
88	520-098	Neck Pad
89	530-064	Screw
90	550-045	T-Washer
91	530-027	Hinge Bolt
92	520-165	Washer
93	530-545	Washer
94	520-012	Front Yoke
95	505-101	Neck Ring Assembly, (Latex) Medium
96	530-308	Hex Nut
97	530-525	Washer
98	515-035	Communications Post
99	510-481	O-ring
100	550-043	Plug
101	515-062	Terminal Block
102	550-040	Nut
103	505-047	W.P. Connector Assembly
104	515-029	Microphone Assembly
105	515-019	Earphone, Left, 15.5"
106	515-018	Earphone, Right, 9"
107	515-033	Communications Set
108	510-575	Nose Block Pad
109	545-015	Nose Block Device <i>Includes location #108</i>
110	520-020	Valve Body
111	510-550	Valve, Oral Nasal
112	510-747	Oral Nasal Mask
113	550-081	Nut, Regulator Mount
114	510-490	O-ring
115	540-054	Earphone Retainer
116	530-527	Washer
117	530-018	Screw
118	530-702	Snap
119	530-519	Washer
120	530-031	Screw
121	530-702	Snap
122	530-519	Washer

**⚠ CAUTION**

**Use only Kirby Morgan original replacement parts. The use of other manufacturers' parts will interfere with the performance characteristics of your life support equipment and may jeopardize your safety. Additionally, any substitutions will void any warranties offered by KMDSI. When ordering spares, always insist on Kirby Morgan original parts.**



Kirby Morgan Dive Systems, Inc.® 1430 Jason Way, Santa Maria, CA 93455

Phone: 805/928-7772 Fax: 805/928-0342

[www.KirbyMorgan.com](http://www.KirbyMorgan.com) e-mail: [kmdsi@KirbyMorgan.com](mailto:kmdsi@KirbyMorgan.com)

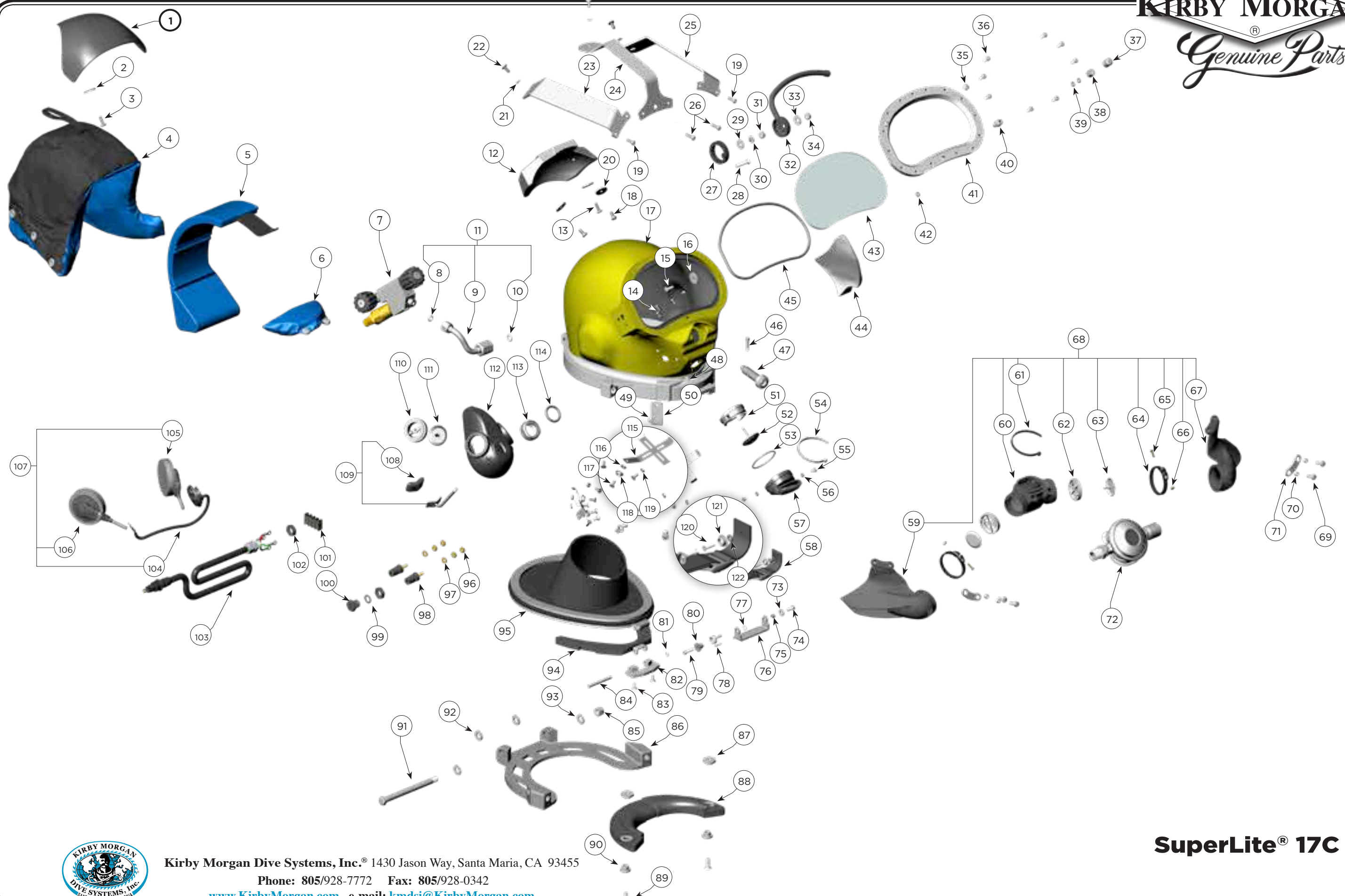

Kirby Morgan Dive Systems, Inc.<sup>®</sup> 1430 Jason Way, Santa Maria, CA 93455  
 Phone: 805/928-7772 Fax: 805/928-0342  
[www.KirbyMorgan.com](http://www.KirbyMorgan.com) e-mail: [kmdsi@KirbyMorgan.com](mailto:kmdsi@KirbyMorgan.com)

**SuperLite<sup>®</sup> 17C Helmet**