

Handle on Stainless Steel Helmets

Contents

SSHNDL-1 1.1 Handle On Stainless Steel Helmets

SSHNDL-1 1.1.1 Handle Removal On Stainless Steel Helmets

SSHNDL-2 1.1.2 Rubber Handle Grip On Stainless Steel Helmets

SSHNDL-2 1.1.2.1 Rubber Handle Grip Removal On Stainless Steel Helmets

SSHNDL-2 1.1.2.2 Rubber Handle Grip Replacement On Stainless Steel Helmets

SSHNDL-3 1.1.3 Handle Replacement On Stainless Steel Helmets

1.1 Handle On Stainless Steel Helmets

1.1.1 Handle Removal On Stainless Steel Helmets

Tools required:

- Flat Blade Screwdriver
- Torque Screwdriver and Flat Blade Attachment

The handle is a convenient location to mount cameras, lights, and other accessories.

1) The handle is removed by first unscrewing the front three handle retainer screws.

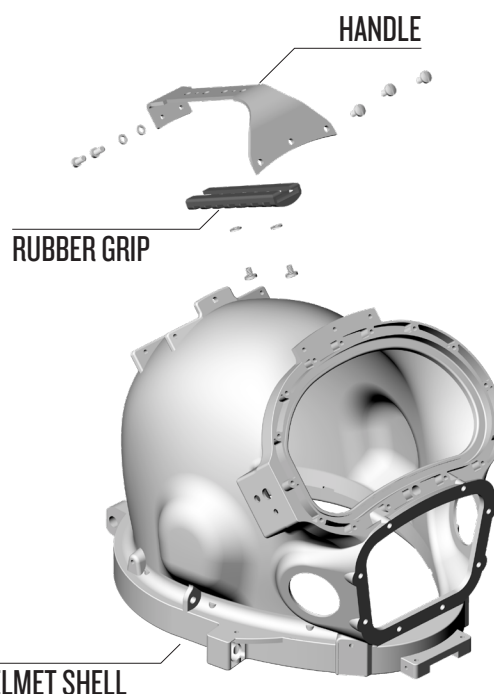

Blowapart drawing of the handle and helmet shell.

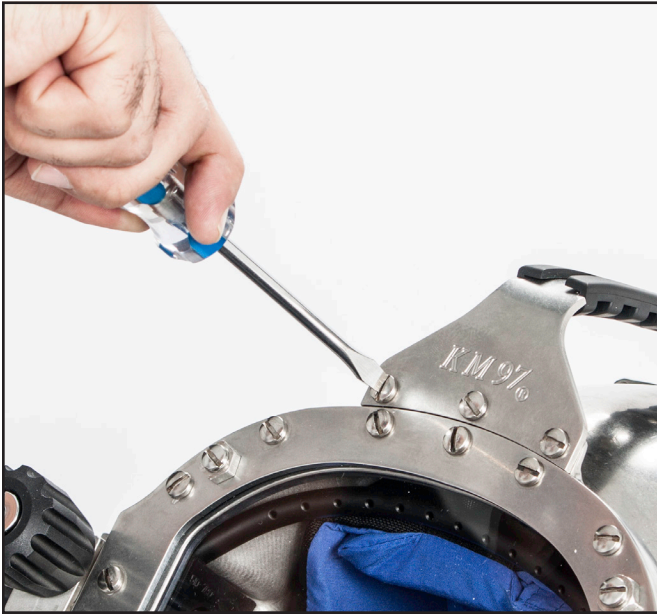

Unscrew the front three handle retainer screws.

2) Remove the rear handle mount screws and washers. You can then remove the handle.



Remove the screws at the rear of the handle.



The handle can be replaced easily.

1.1.2 Rubber Handle Grip On Stainless Steel Helmets

Tools required:

- Flat Blade Torque Screwdriver
- Loctite® 248

The rubber grip on the handle is easily replaced.

1.1.2.1 Rubber Handle Grip Removal On Stainless Steel Helmets

- 1) Remove the screws and washers.
- 2) Pull the rubber off the handle.

1.1.2.2 Rubber Handle Grip Replacement On Stainless Steel Helmets

- 1) Slide a new grip onto the handle.
- 2) Install the screws and washers with Loctite® 248 and tighten to just until rubber begins to extrude. The tips of the screws will protrude slightly from the other side of the handle.



Tighten the screws to just until rubber begins to extrude. The tips will protrude slightly through the other side of the handle.

1.1.3 Handle Replacement On Stainless Steel Helmets

- 1) Position the handle on the helmet.
- 2) Apply Loctite® 248 to the screws. Install all of the screws, both front and rear, finger tight. Be sure to install the washers with the rear screws.
- 3) Gradually tighten the screws in a staggered pattern, back to front.
- 4) Tighten the front screws see “Torque Specs” on page APNDX-19 for correct torque.



Tighten the screws on the front of the handle see “Torque Specs” on page APNDX-19 for correct torque.

- 5) Tighten the rear screws see “Torque Specs” on page APNDX-19 for correct torque.



Tighten the screws on the rear of the handle see “Torque Specs” on page APNDX-19 for correct torque.