

Handle on Fiberglass Helmets

Contents

HNDL-1 1.1 Handle On Fiberglass Helmets

HNDL-2 1.2 Handle Replacement On Fiberglass Helmets

HNDL-1 1.1.1 Handle Removal

1.1 Handle On Fiberglass Helmets

1.1.1 Handle Removal

Tools required:

- Flat Blade Screwdriver
- Torque Screwdriver and Flat Blade Attachment
- Dow Corning® RTV 732 Multi Purpose Sealant or Equivalent

The handle is a convenient location to mount cameras, lights, and other accessories. If the handle is to be drilled to accept any of these items, it

must be removed to prevent accidental damage to the helmet shell.



NOTE

Weights only need to be removed if fiberglass damage of the helmet shell is suspected or mounting holes are to be drilled and tapped into the weights for camera or light mounting.

1. The handle is removed by first unscrewing the top three port retainer screws.

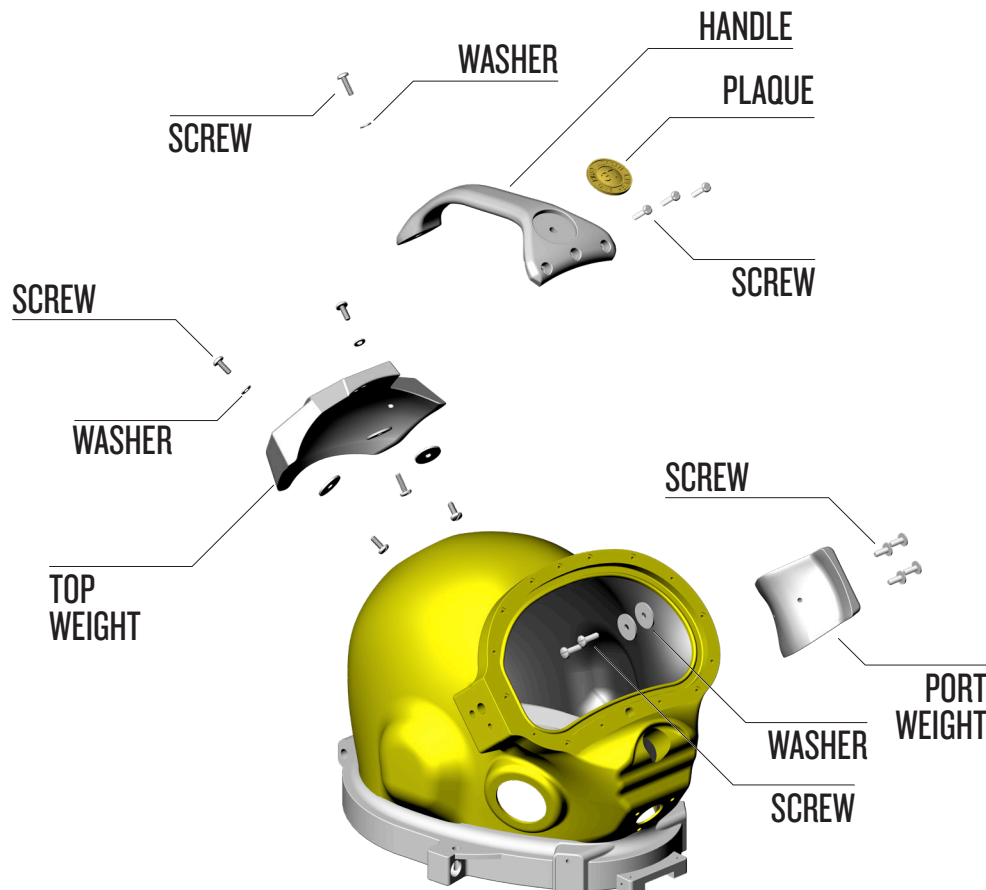

Blowpart of the handle and weights.



Unscrew the top three port retainer screws.

2. Remove the rear handle mount screw and washer.



Remove the screw at the rear of the handle.

1.1.2 Handle Replacement On Fiberglass Helmets

1. Apply a thin bead of Dow Corning® RTV 732 multipurpose sealant or an equivalent product around the rear mounting hole on the handle.

2. Position the handle and partially tighten the front screws until they are snug.



Position the handle on the helmet.

3. Hold the handle securely in place and carefully thread the rear mounting screw with its washer until it is snug.

4. Torque the front mount screws. See "Torque Specs" module.

5. Torque the rear mount screw. See "Torque Specs" module.

6. Ensure that any excess RTV sealant is wiped off from both the inside and outside, as required by the specific model.