



Kirby Morgan Dive Systems, Inc.®

1430 Jason Way Santa Maria, California 93455

Phone: 805/928-7772 Fax: 805/928-0342

www.KirbyMorgan.com email: kmdsi@KirbyMorgan.com

Part #525-190 BandMask® 18/28 with 455 Balanced Regulator Water Shroud Kit Installation Instructions

PART #	DESCRIPTION	QTY	PART #	DESCRIPTION	QTY
510-597	Side Block Shroud	1	520-049	Tie Wrap	4
510-723	Regulator Shroud, 455	1	550-074	Bishop Pin	2
510-733	Access Cover	1	550-572	Adapter Sleeve	1
510-736	Water Tube A	1	550-580	Adapter Sleeve, Long	1
510-737	Water Tube B	1	550-648	Pin	2
520-039	Tie Wrap	6			

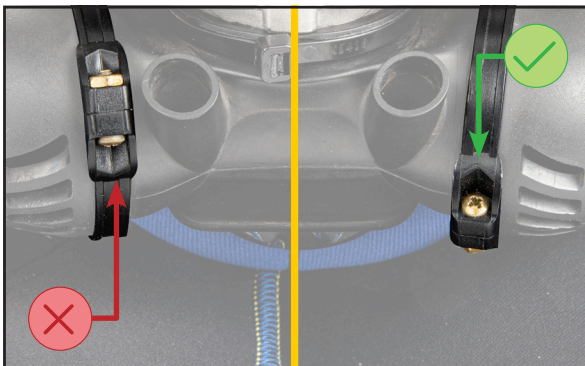

VIDEO



How to: Bandmask® Water Shroud Kit Installation

<https://www.youtube.com/watch?v=wb88FgpFuGI>

Rotating the clamps will allow more clearance when installing the regulator shroud, making the installation easier.

Tools Required:

- Torque Screwdriver
- Torque Wrench
- Open End Attachments
1¹/₆, 7⁷/₈ and 1 inch
- Open Ended Wrenches
1¹/₆, 7⁷/₈ and 1 inch
- 1/4 inch Flat Blade Screwdriver
- Small Phillips Screwdriver
- Small Cutting Pliers
- Dow Corning® Molykote® 111 Lubricant or Equivalent



Kirby Morgan Dive Systems, Inc.®

1430 Jason Way Santa Maria, California 93455

Phone: 805/928-7772 Fax: 805/928-0342

www.KirbyMorgan.com email: kmdsi@KirbyMorgan.com



1) Remove and replace the lower two screws with the bishop pins. Torque the screws evenly. See the “Torque Specs” module for correct torque.

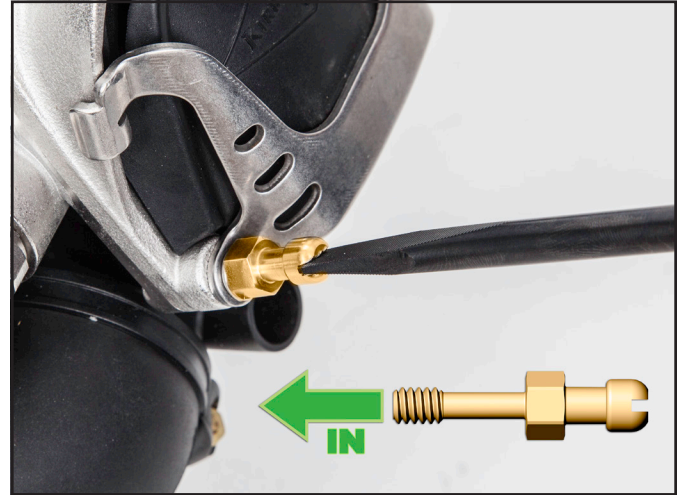

Side Block

NUMBERS REFER TO STEPS AT RIGHT

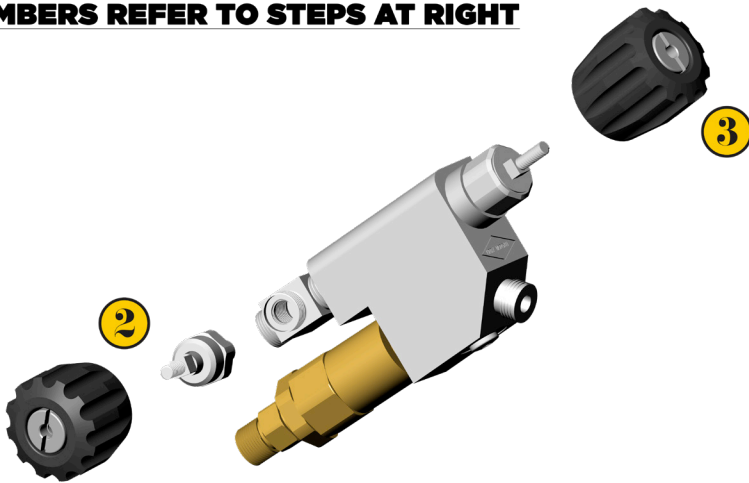

2) Remove the emergency valve control knob, screw, spring, washer, packing nut and stem.

3) Remove the steady flow control knob, screw, spring and washer.

4) Remove the bent tube assembly. Refer to “1.3.1 Removal of the Bent Tube Assembly” on page BNT-4 in the KMDSI modular manual.

5) Install the side block shroud. Insert the non-return and emergency valves through the square opening in the back of the shroud. Stretch the shroud over the side block body, free flow valve and bent tube connection on the opposite end of the block. Stretch the small hole in the side of the shroud over the threaded valve stem opening on the emergency valve.

Fit the shroud onto the block while progressing towards the front of the block. Make certain the shroud is positioned properly.





Kirby Morgan Dive Systems, Inc.®

1430 Jason Way Santa Maria, California 93455

Phone: 805/928-7772 Fax: 805/928-0342

www.KirbyMorgan.com email: kmdsi@KirbyMorgan.com



6) Reinstall all of the side block parts that were removed except the bent tube assembly.

Regulator Shroud

7) Lightly lubricate the opening of the regulator shroud, 455 P/N 510-723, where the adjustment knob of the regulator will pass through.

Notice the opening is surrounded by many fine slices to allow the shroud in that area, to easily spread over the large end of the adjustment knob.

8) Starting at the adjustment knob end of the regulator, slip the regulator shroud over the adjustment knob.

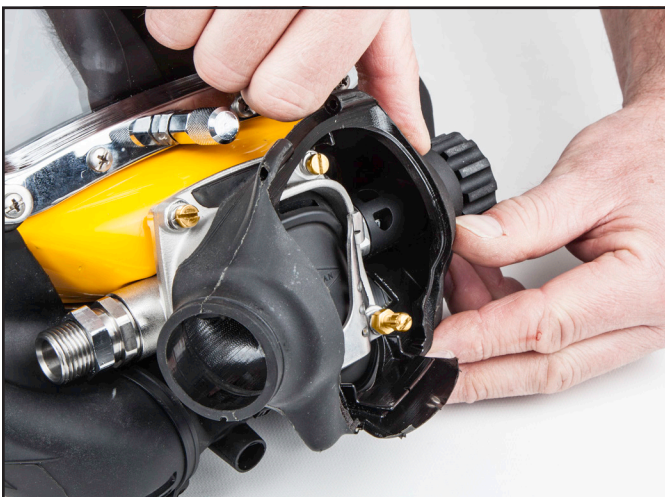

Kirby Morgan Dive Systems, Inc.®

1430 Jason Way Santa Maria, California 93455

Phone: 805/928-7772 Fax: 805/928-0342

www.KirbyMorgan.com email: kmcsi@KirbyMorgan.com



Bent Tube

9) Insert bent tube assembly into regulator inlet side and line up the bent tube mount nut to the side block.

The adapter sleeves have to be inserted onto the bent tube assembly and remain loose while the bent tube is being installed. The channeled ends of the sleeves will be facing each other while installing the bent tube assembly.



10) Swing the bent tube away from the side block and put the adapter sleeve (short), P/N 550-572, onto the bent tube assembly first, channeled end facing away from regulator inlet.

UPPER (SIDE BLOCK)



LOWER (REGULATOR)

11) Fit the adapter sleeve, long, P/N 550-580, over the bent tube assembly, channeled end facing away from the side block.

12) Complete installation of bent tube assembly. Refer to "1.3.3 Installation of the Bent Tube Assembly" on page BNT-4 from the KMDSI modular manual.





Kirby Morgan Dive Systems, Inc.®

1430 Jason Way Santa Maria, California 93455

Phone: 805/928-7772 Fax: 805/928-0342

www.KirbyMorgan.com email: kmdsi@KirbyMorgan.com

13) Line up the detail features of water tubes A & B, with the mating details of both adapter sleeves.

Water flow arrow is found on the A tube and should be positioned farthest away from the helmet (on the outside)



14) Secure the two tubes in this position using the wider tie wraps first.

Three tie wraps, P/N 520-039, will be used (represented by the blue color in the photo), one in the middle and one on each of the leading edges of the tube. Little to no gap should be evident between the two tubes.

15) Using two narrower tie wraps, P/N 520-049, (represented by the yellow color in the photo), secure both the side block and regulator shrouds to the sleeves.

Regulator Shroud



Knurled ends of the pins should be located on the outer edges, **NOT** in the middle.

16) Align the access cover, P/N 510-733, to the regulator shroud P/N 510-723, as shown and install the two pins, P/N 550-648, until the leading edges are flush with the outside of the access cover and evenly located into the area of the regulator shroud where it will remain.



Kirby Morgan Dive Systems, Inc.®

1430 Jason Way Santa Maria, California 93455

Phone: 805/928-7772 Fax: 805/928-0342

www.KirbyMorgan.com email: kmdsi@KirbyMorgan.com



17) Close the access cover and secure by pushing over the bishop pins. Make sure the regulator shroud and access cover line up correctly and no part is pinched or tucked.

Generally between one-two gallons per minute of water flow is plenty to heat the incoming gas or to keep the interior clean of debris without interfering with the regulator diaphragm.



This page intentionally left blank.



Kirby Morgan Dive Systems, Inc.
1430 Jason Way
Santa Maria, CA 93455, USA
Telephone (805) 928-7772, FAX (805) 928-0342
E-Mail: KMDSI@KirbyMorgan.com, Web Site: www.KirbyMorgan.com