



Kirby Morgan Dive Systems, Inc.®

1430 Jason Way Santa Maria, California 93455

Phone: 805/928-7772 Fax: 805/928-0342

www.KirbyMorgan.com email: kmdsi@KirbyMorgan.com

PART #525-210 Sealed Pull Pin Kit For the SuperLite 27 & SuperLite 17C

The Kirby Morgan Lock Pin Kit is designed for use on the SuperLite 27 and 17C helmets during fine silt jetting operations.

Parts included in the Kit:

P/N	Description	Qty.
505-110	Pull Pin Ass'y	2
530-015	Screw	2
510-626	Rubber Hole Plug	2

TOOLS REQUIRED:

9/64 inch Allen wrench attachment on a torque screwdriver

Loctite® 222 Threadlocker

Silicone sealant

Installation:

- 1) See Figure 1. Remove all of the four way locking mechanisms parts. This is done by taking out the release pin screws (6) on the helmet ring and catch pin screw (3) on the locking collar. The release pins (4) catch pins (1) and springs (2) may now be removed. These parts are not used with the new system but must be returned to the dealer along with the serial number of your helmet to receive the sealed pins free of charge.
- 2) The front lugs on the ring are predrilled for the sealed pins. These holes have rubber plugs (7) which should now be removed, cleaned and reinstalled with a small amount of silicone sealant *in the middle holes where the release pin screw (6) was removed*. Two additional plugs come with the kit. Install these in the collar holes where the catch pin screws (3) were removed.
- 3) Clean out the hole that the plug was removed from. The sealed pull pins (5) do not have a left or right. They are slotted on both sides which allows them to be used on either side of the helmet. Install the pin assemblies so that the longest side of the plunger is on top. This way the collar pushes

⚠ CAUTION

Use only KMDSI original replacement parts. The use of other manufacturer's parts will interfere with the performance characteristics of your life support equipment and may jeopardize your safety. Additionally, any substitutions will void any warranties offered by KMDSI. When ordering spares, always insist on Kirby Morgan Genuine Parts.

Kirby Morgan Dive Systems, Inc.®

1430 Jason Way Santa Maria, California 93455

Phone: 805/928-7772 Fax: 805/928-0342

www.KirbyMorgan.com email: kmdsi@KirbyMorgan.com

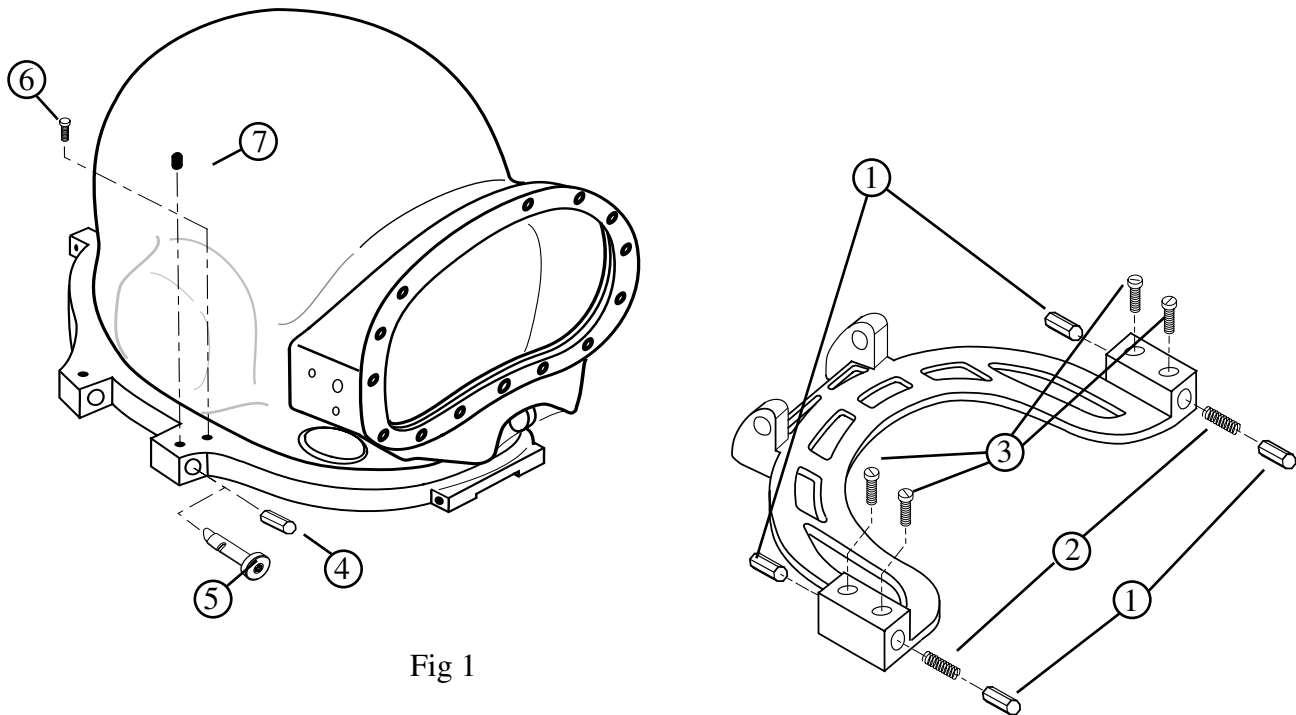

Fig 1

the plunger open when closing the collar, allowing hands free operation. When the assembly is correctly oriented the new Allen screw should be installed. Apply Loctite to the threads and torque the screw to thirty four inch pounds. To open, each pin can be pulled open and turned 1/4 turn to keep it open or both pins can be pulled without turning to allow the collar to drop and then released to the closed position.

Maintenance:

The sealed pull pin is sold and installed as a unit. The pull pin must not be disassembled by anyone other than an authorized KMDSI Dealer trained for this work. The pull pin must have the O-rings and fluid changed at least every 400 working hours or once a year, which ever comes first.

Suggestion:

An extra pull pin should be kept on hand in case one needs to be changed out on the job site or the third pin could be rotated out for yearly maintenance so the helmet can be kept in constant use. *The pin assemblies should be inspected after every dive to make sure that they have full and free movement.*