



# Kirby Morgan Dive Systems, Inc.®

1430 Jason Way Santa Maria, California 93455

Phone: 805/928-7772 Fax: 805/928-0342

www.KirbyMorgan.com email: kmdsi@KirbyMorgan.com

## Part # 525-120 SuperLite-27 Double Exhaust Kit

Location	Part Number	Description
1	510-635	Double Exhaust Whisker
2	520-042	Tie Wrap (3) (11")
3	510-552	Exhaust Valve (2)*
4	540-118	Valve Body* (metal)
5	520-020	Valve Body * (plastic)
6	510-550	Valve*
7	530-035	Screw (2)
8	510-557	Water Dump Valve

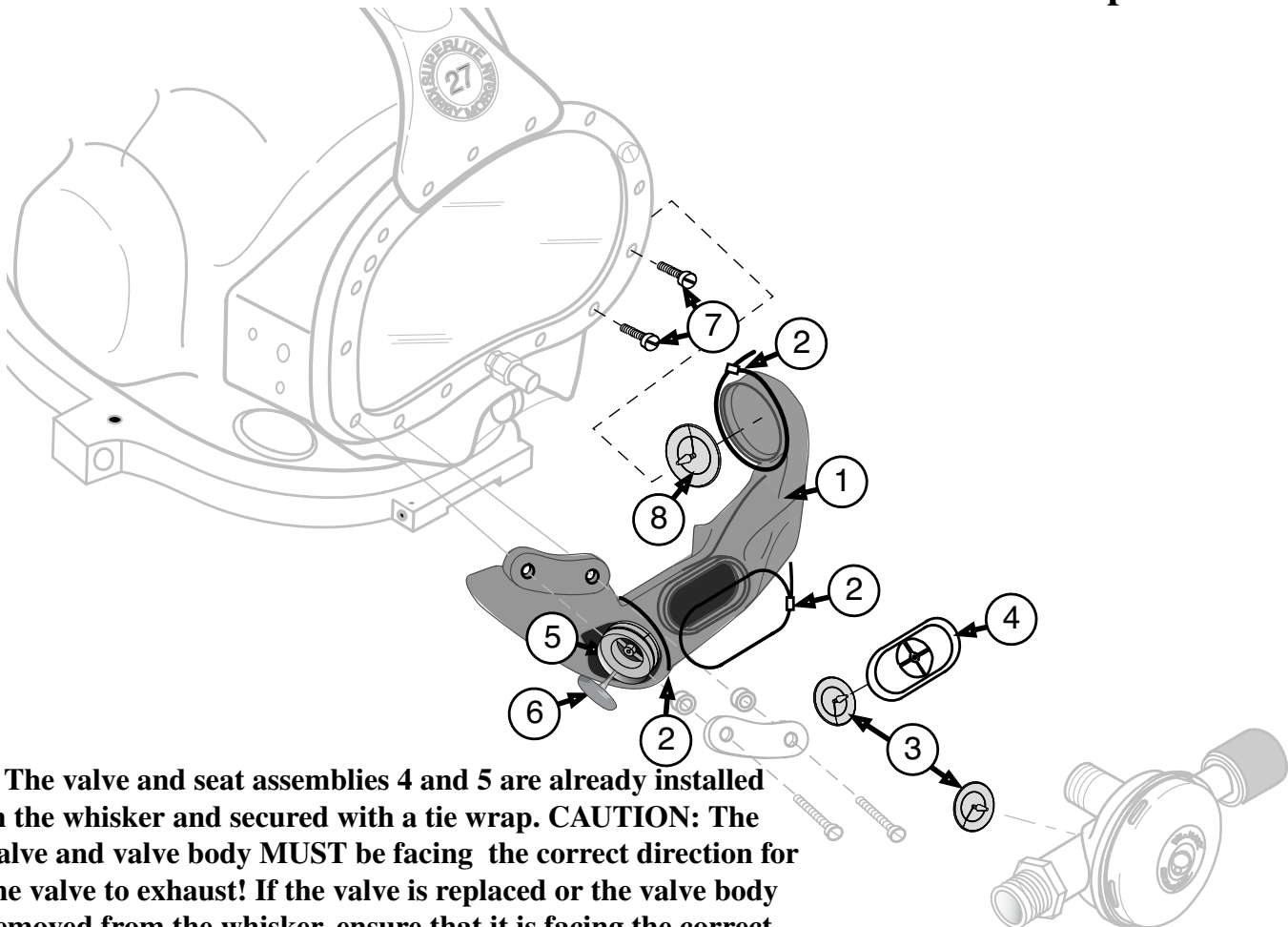

\* The valve and seat assemblies 4 and 5 are already installed in the whisker and secured with a tie wrap. **CAUTION:** The valve and valve body **MUST** be facing the correct direction for the valve to exhaust! If the valve is replaced or the valve body removed from the whisker, ensure that it is facing the correct direction when reinstalled! (See drawing)

# Kirby Morgan Dive Systems, Inc.®

1430 Jason Way Santa Maria, California 93455

Phone: 805/928-7772 Fax: 805/928-0342

www.KirbyMorgan.com email: kmdsi@KirbyMorgan.com



## Installation instructions

1. Remove the two Whisker Kidney Plates and Spacers and Screws. One set of these will be used in the installation/reassembly.

2. Following the instructions in the Operations and Maintenance Manual, remove the Regulator, Exhaust Whisker and Water Dump Shroud. This will require removal of the Nose Block Device, Oral Nasal and Bent Tube.

3. Following the instructions in the Operations and Maintenance Manual remove the Regulator Cover & Diaphragm. Replace the Regulator Exhaust Valve with a new, 510-552 (white valve) (3) . Reassemble the Regulator.

4. Attach the Double Exhaust Whisker (1) to the Regulator Exhaust Flange (A). Secure (B) with a Tie Wrap 520-042 (2).

5. Replace the Water Dump Valve with the new 510-557 (blue valve) (8).

6. Install the Regulator/Whisker Assembly in the Helmet (C), with the Regulator Nut hand tight.

7. Attach the Double Exhaust Whisker to the Water Dump Body. Make sure the internal rubber ridge is in the groove in the Water Dump Body. Secure it (D) with a Tie Wrap 520-042 (9)

9. Attach the Bent Tube.

10. Secure the outlet side of the Whisker with the two Screws, Spacers and Kidney Plate removed earlier.

11. Use the two new short 535-035 Screws (7) in place of the previously removed Screws and Kidney Plate on the left side of the Port Retainer.

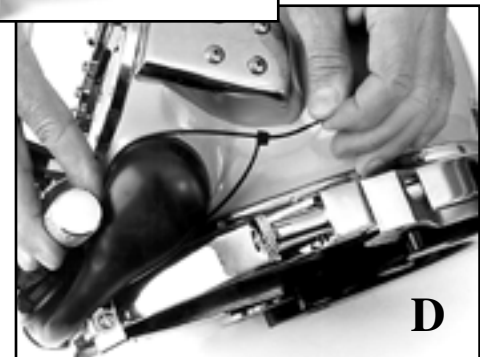
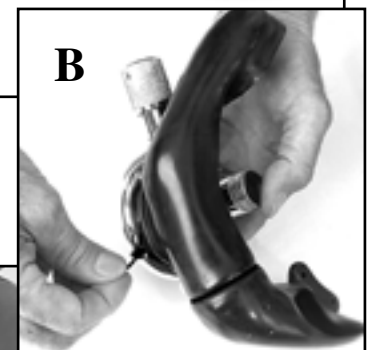
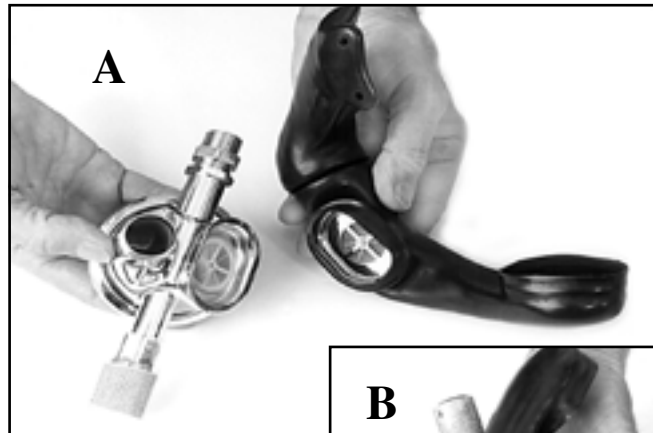

**CAUTION! Do not use the screws removed earlier!  
Using these will damage the helmet!**

12. Tighten the Regulator Nut and Bent Tube attachments to the correct torques found in the manual.

13. Reinstall the Oral Nasal & Nose Block Device.