



Kirby Morgan Dive Systems, Inc.®

1430 Jason Way Santa Maria, California 93455

Phone: 805/928-7772 Fax: 805/928-0342

www.KirbyMorgan.com email: kmdsi@KirbyMorgan.com

PART #525-103 WHISKER ONLY, DOUBLE EXHAUST for SL-17 HELMETS & KMB 18 BAND MASK

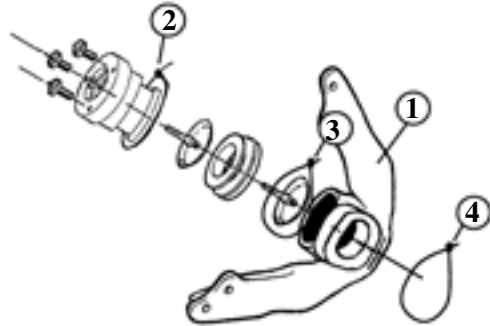

LOC #	PART #	DESCRIPTION
1	510-558	DOUBLE EXHAUST WHISKER
2,3 & 4	520-042	TIE WRAP

Tools required: Flat blade screwdriver & adjustable torque screw driver.

Any Helmet/Dry Suit System must be leak tested according to manufacturer's instructions before every dive in contaminated water !

Installation Instructions:

1) Remove the regulator and whisker as per instructions in the owners manual. Cut the tie-wrap that holds the whisker to the double exhaust metal body and remove the whisker from the body.

2) Cut the tie-wrap that holds the whisker to the regulator and remove the whisker from the regulator. Cut the tie-wrap that holds the second exhaust body in the whisker. **NOTE the direction that the body and valve faces in the whisker.** Remove the valve body and install it into the new whisker and tie-wrap (3) it in, making sure that the tie-wrap clamp is at the bottom of the whisker.

3) Stretch the new double exhaust kit whisker onto the regulator flange and install tie-wrap (2) *loosely* around whisker on the regulator flange. Place the regulator back into the nose hole of the helmet/mask frame. Stretch the double exhaust kit whisker over the special main exhaust body insuring the whisker is seated properly on the main exhaust body flange. Install tie-wrap (4) *snugly* around whisker on the exhaust body flange **making sure that the tie wrap is in the slot on the exhaust body!** This is very important to the sealing of the exhaust! Tighten the regulator flange tie-wrap snugly around the whisker, insuring that it does not become pinched between the helmet/mask frame & regulator. Cut off excess tie wrap ends.



Mount whisker to regulator.

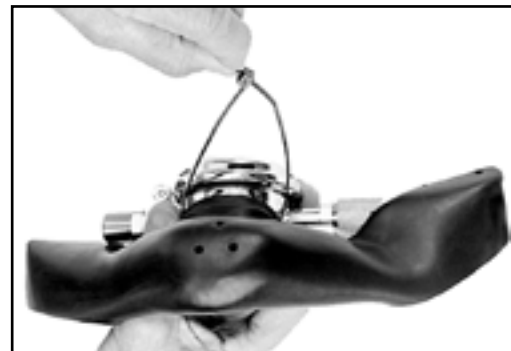

*Install tie wrap (2) **loosely** around whisker on the regulator flange.*

4) Remount the regulator following the instructions in the manual. Attach the whisker using the screws, plate, and spacers on each side of the port retainer. Tighten to **12 inch pounds** with a torque adjustable screwdriver. **SPECIAL CARE must always be taken to not over-torque any port retainer screws!**